

Safety Precaution

- **Important:** Installers and users are obliged to familiarise themselves with this manual.
- **Danger:** Power Cables and plugs have high voltage from the battery, be careful when wiring.
- **Important:** Ensure that a fire extinguisher is in place prior to installation and use.
- **Warning:** Installation and operation must be carried out by qualified personnel and the system must be installed in restricted access areas.
- **Caution:** The battery module is with certain weight. Install with the help of tools if necessary.

Contents in SIMPO HV Package

Battery Package:

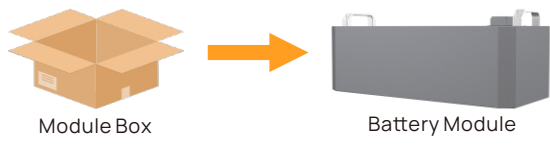

BMS Package:

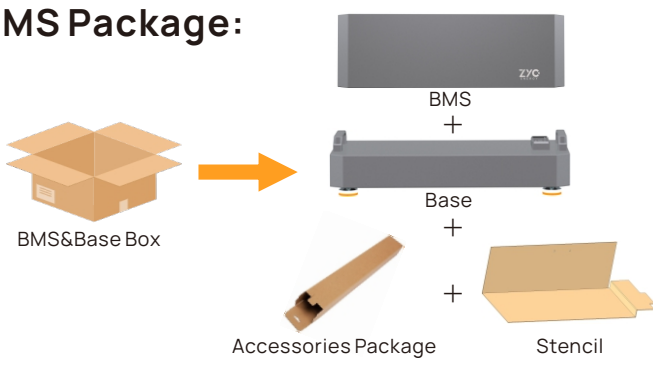

Accessories Included:

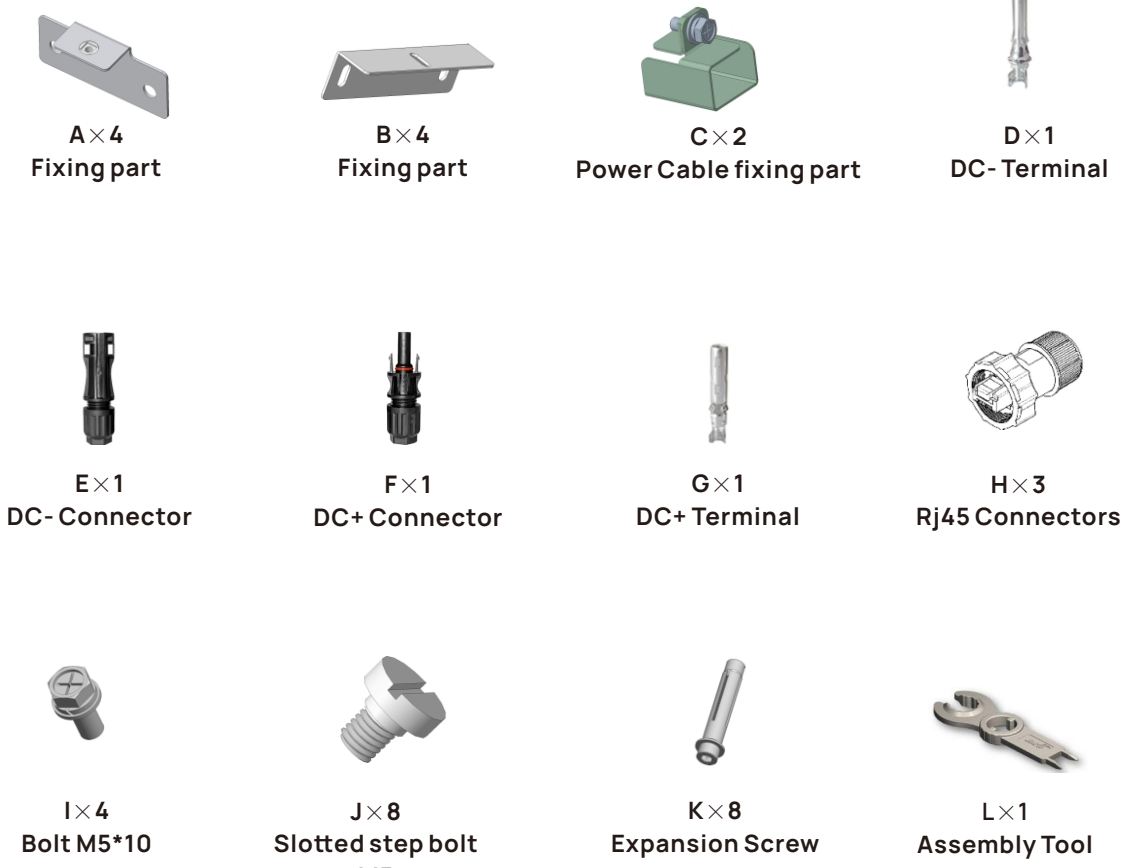

1

Extra Accessories

Extra accessories are not included in the accessory box but necessary for system build up.



DC Cables
(≥10 AWG)



PE Cable with T
terminal (SC10-5)
(≥ 8AWG)



COM Cable
(Cat.5e or Upper)

Tools



Different Functional Area on BMS

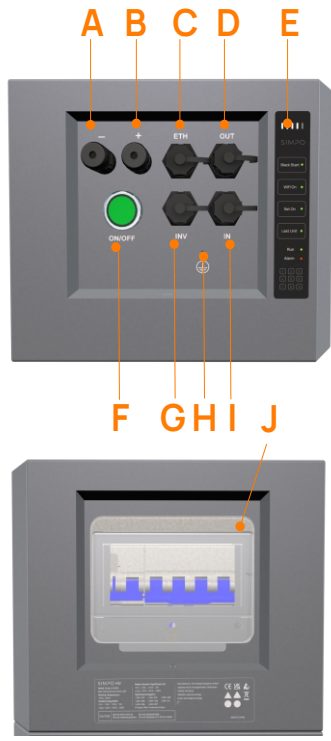

Letter	Lable	Function
A	-	DC-
B	+	DC+
C	ETH	Ethernet
D	OUT	Com Out
E	HMI	Human Machine Interface
F	ON/FF	ON/OFF
G	INV	Inverter COM
H	PE	PE Connection
I	IN	COM In
J	/	Circuit Breaker

2

Place the base

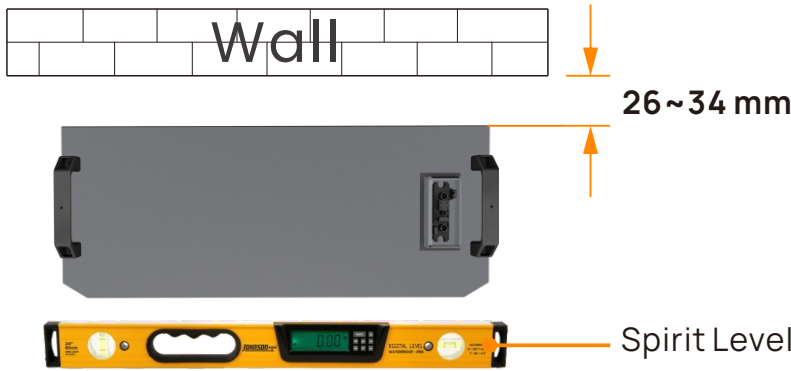

The base should be based on solid floor.
A spirit level is recommended for use when adjusting the feet.

Quantity of Fixing Parts Needed

Number ①-⑨ represent module sequence only in this part.

*Fixing part for BMS is necessary for any amount of modules

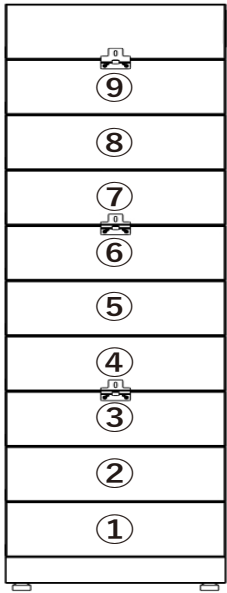

Module Qty per Tower	Qty of fixing parts recommended	Position of module fixing parts
2	NONE	NONE
3	1	③
4	1	④
5	2	③&⑤
6	2	③&⑥
7	2	③&⑦
8	3	③&⑥&⑧
9	3	③&⑥&⑨

Power Cables Crimping

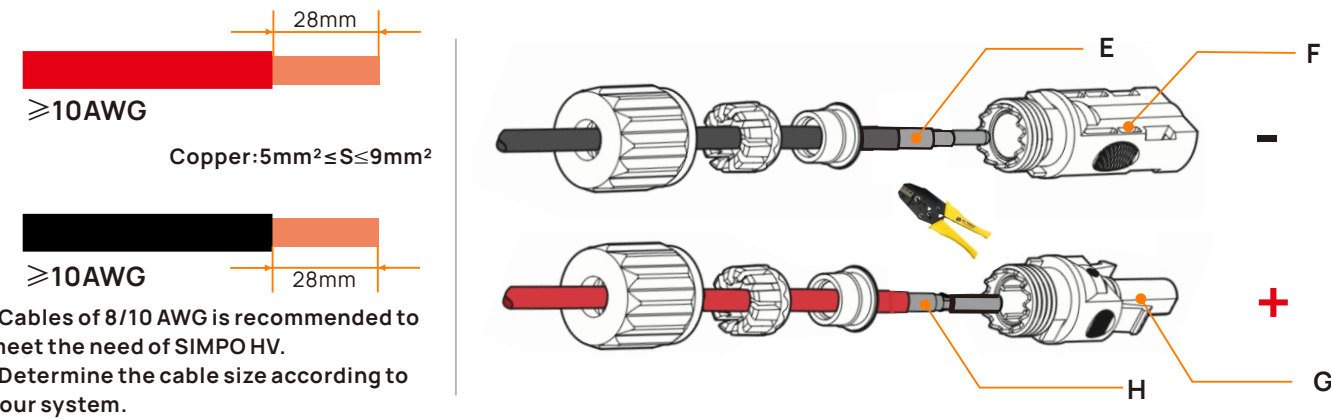

3

Fix To The Wall

Stack up the modules and whenever reaches the quantity of fixing parts needed, follow the instructions below:

Step 1: Locate and drill holes for fixing parts on the wall.
Before stacking up the module that needs to be fixed to the wall, use the stencil to locate the drilling holes and finish the drilling.

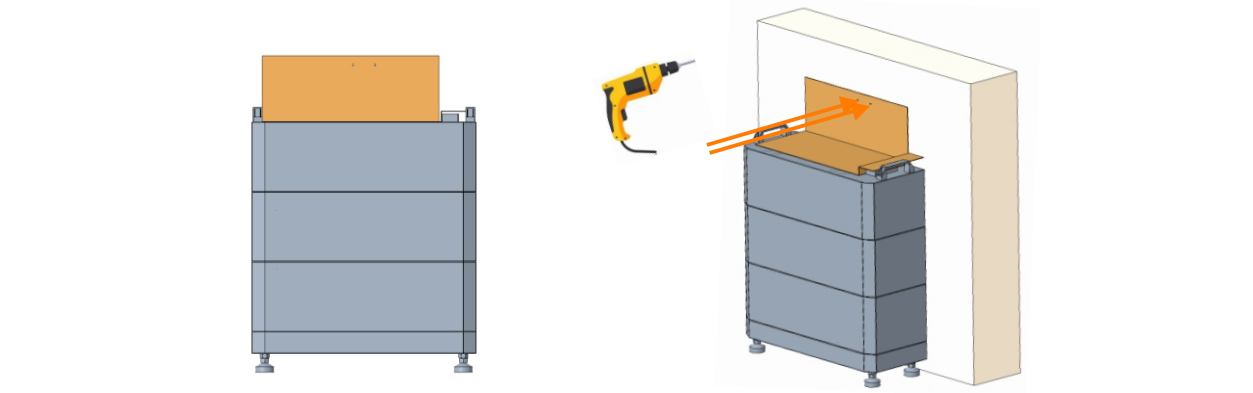

Step 2: Install fixing part A to the wall and fixing part B to the module.

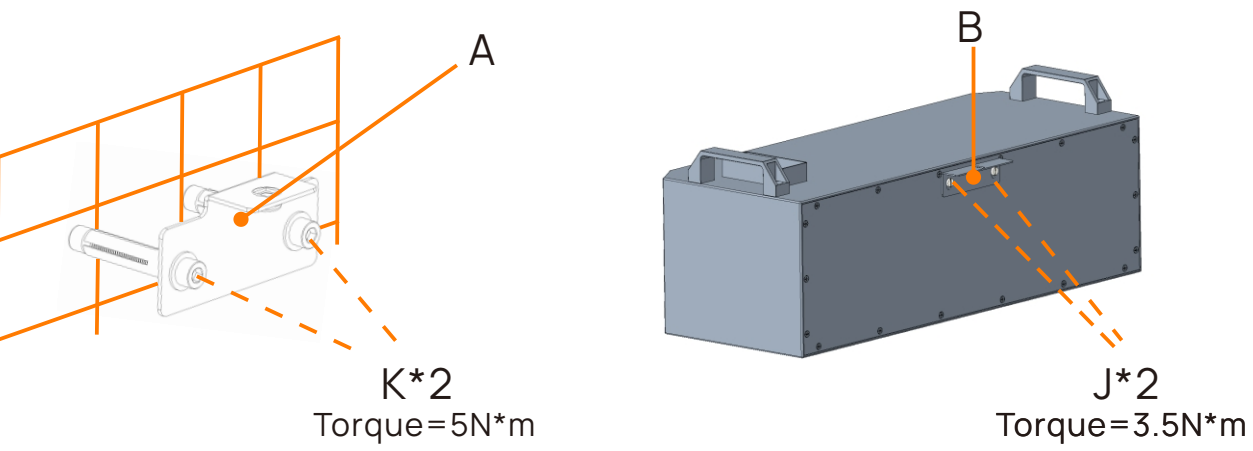

Step 3: Stack up the module and fix the screw between A and B

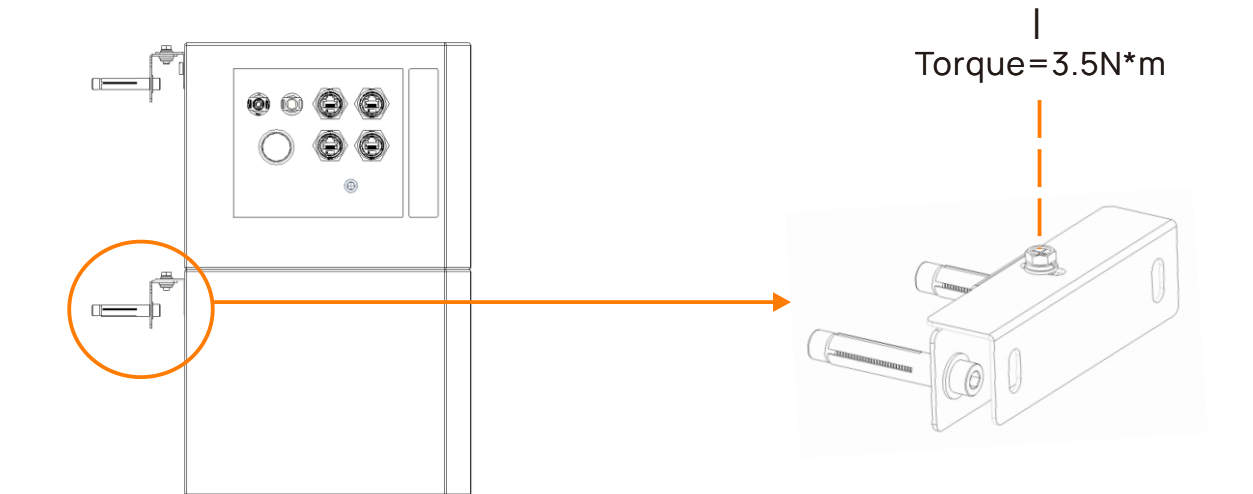

4

Cables Connection

System Overview:

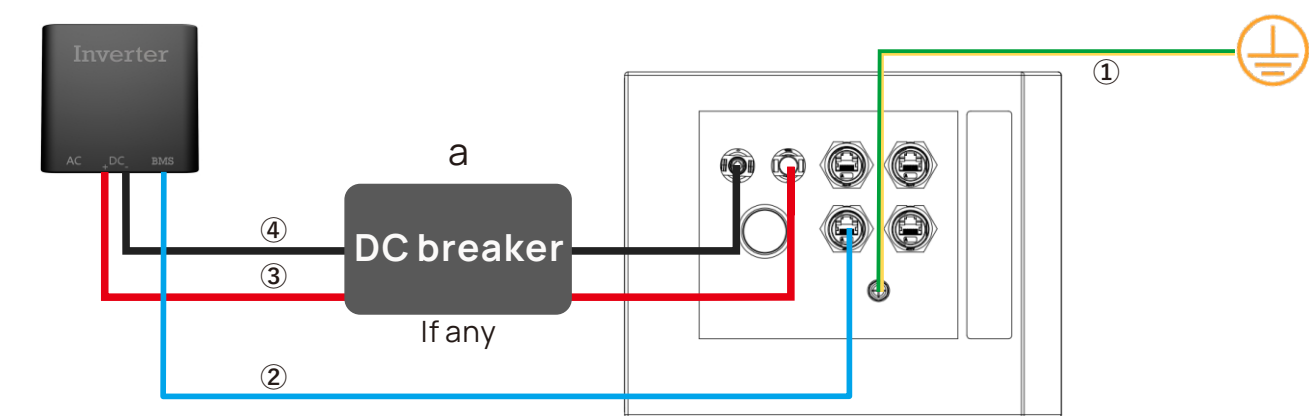

PE Cables Connection:

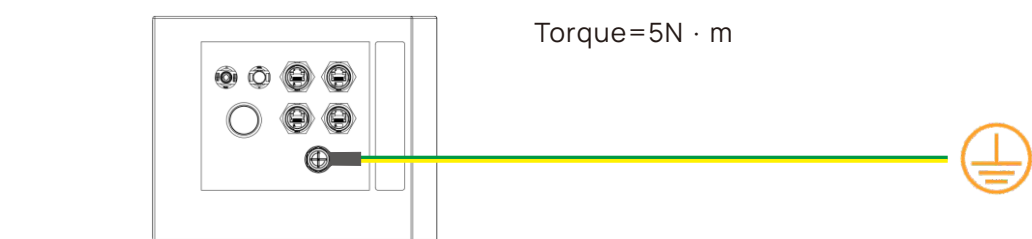

Power Cables Connection:

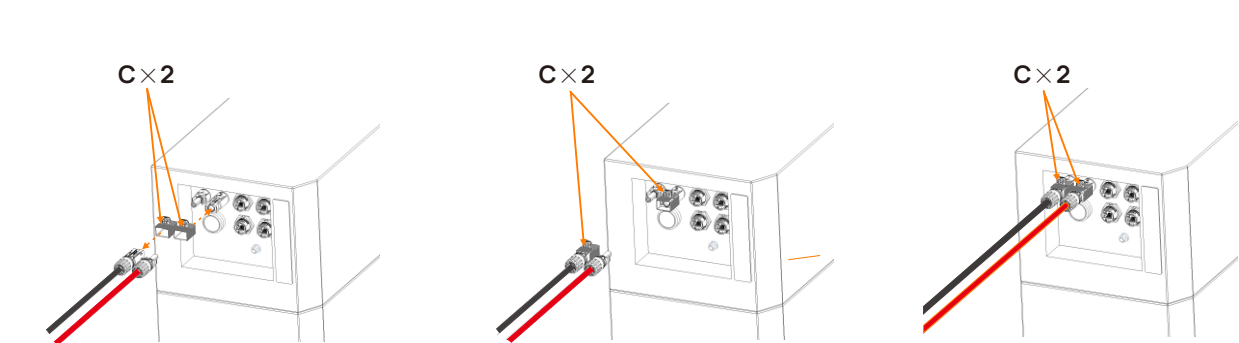

Communication Cables Connection:



Definition of SIMPO HV "INV" Port

PIN NO.	1	2	3	4	5	6	7	8
Definition	11VGND	12V	11V	CAN_H	CAN_L	12VGND	RS485B	RS485A

5

ZYC ENERGY CO., LTD

+86 (0)755-2839 4019

WhatsApp: +86 19168831702

Parallel Multiple Towers

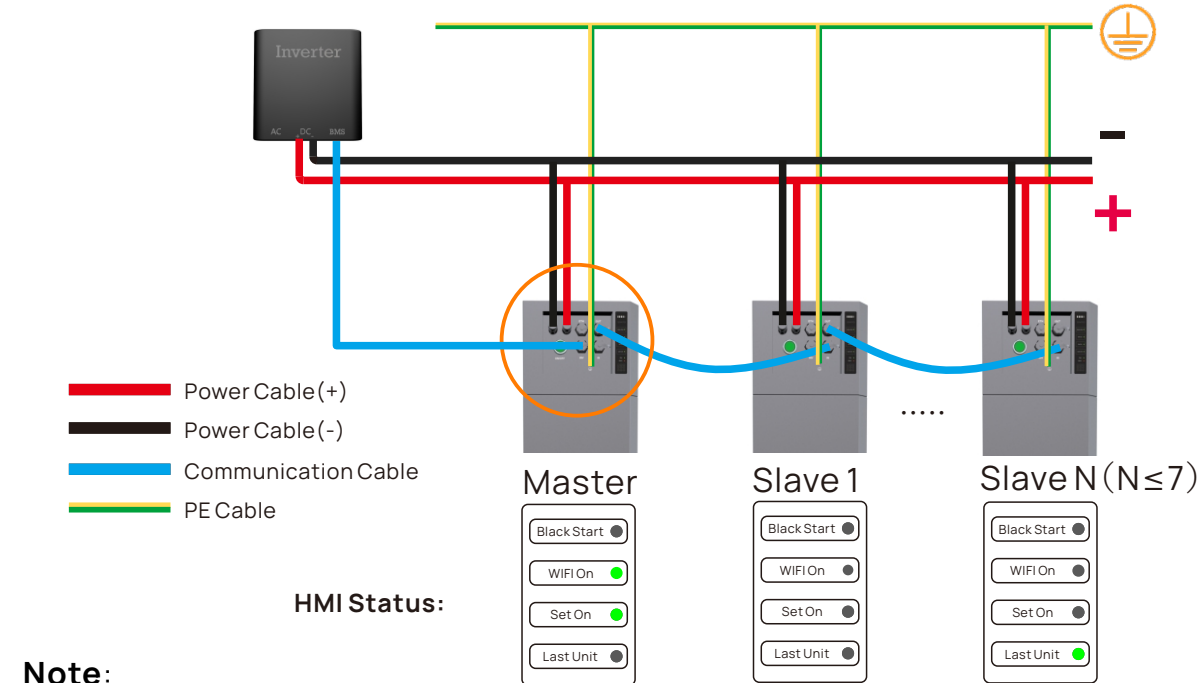

Note:

- When parallel multiple towers (≤ 8) only the 'Set On' LED on master is ON.
- Only the 'Last Unit' LED of last tower (N) is ON.
- Only the 'WiFi On' on master tower will be on for energy saving. This function on slave towers will be turned off by master tower automatically.

Human Machine Interface (HMI)

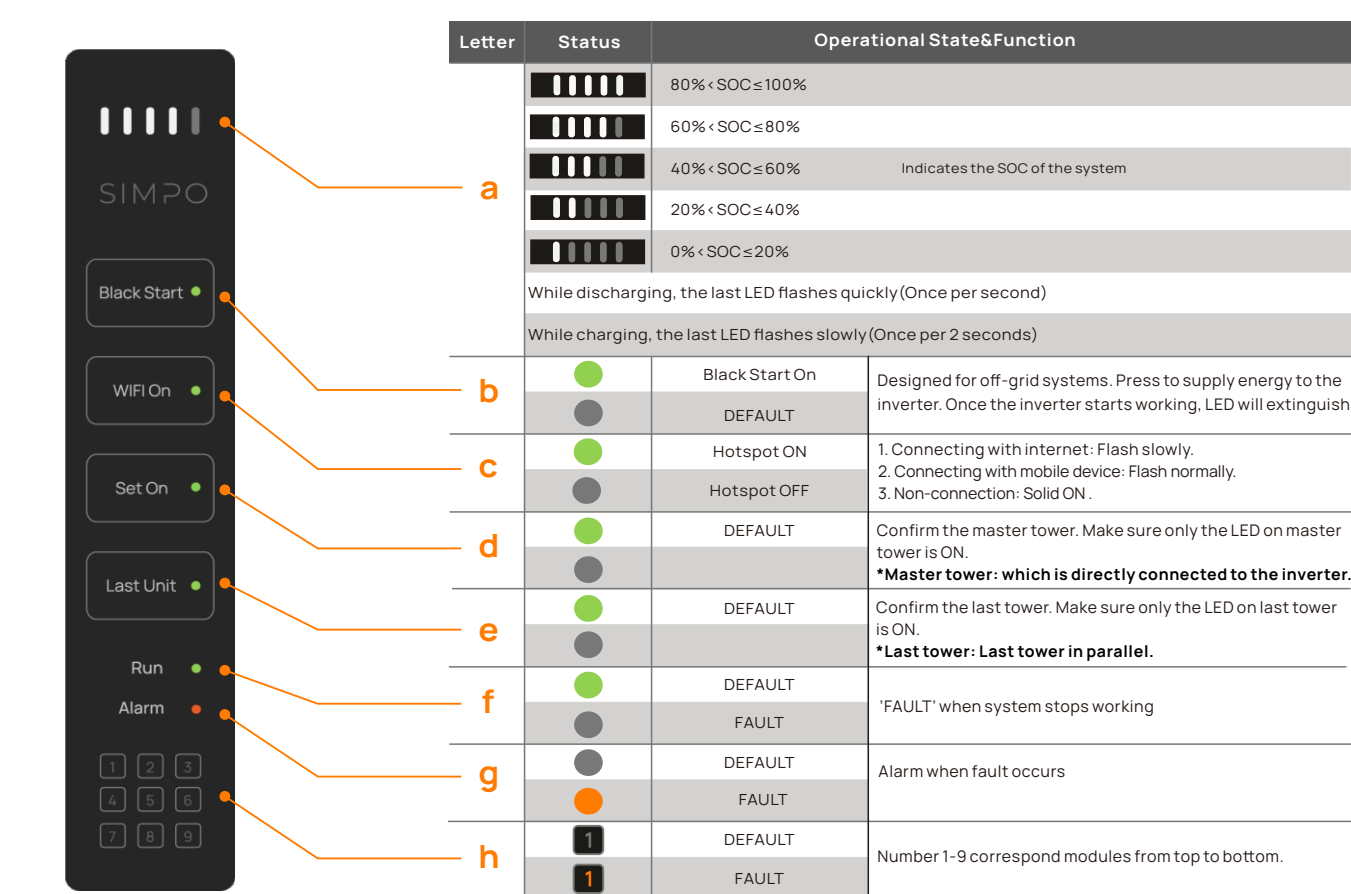

6

sales@zyc.energy / service@zyc.energy

www.zyc.energy / www.zycportal.com

Connection With Inverters

Connecting with Kostal Plenticore Plus G2/ Plenticore G3 / Plenticore BI G2

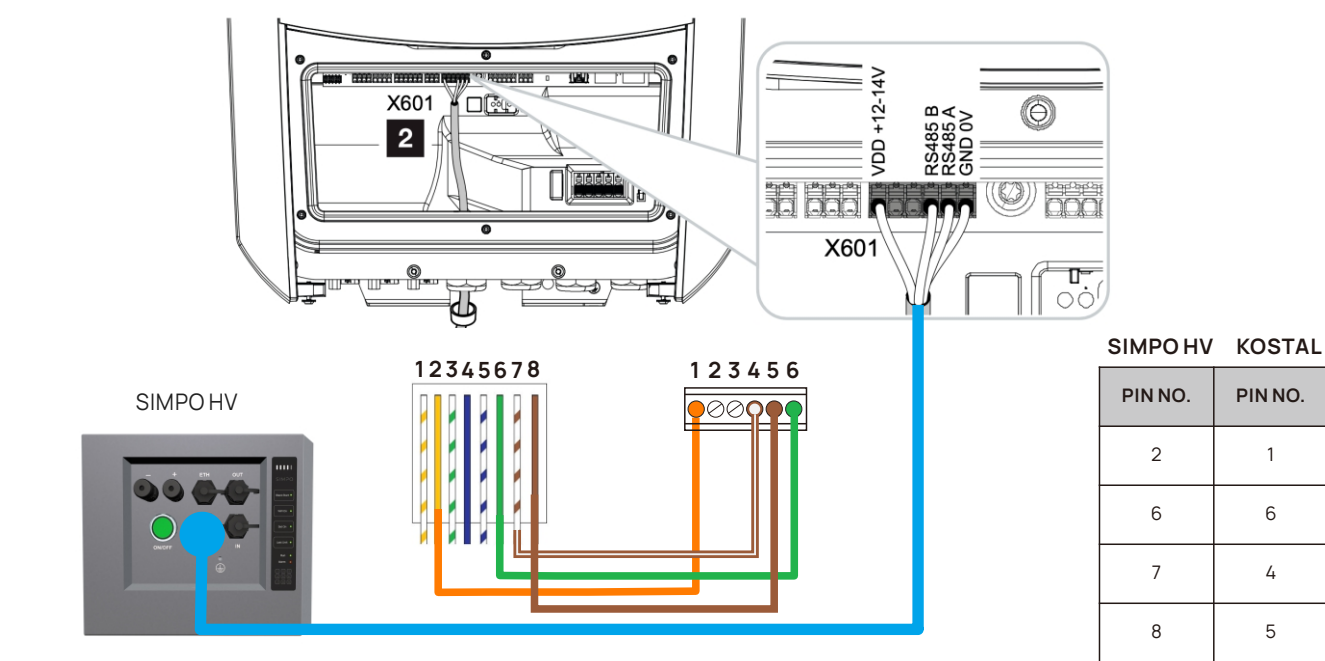

Connecting with Solis S6-EH3P & RHI-3P

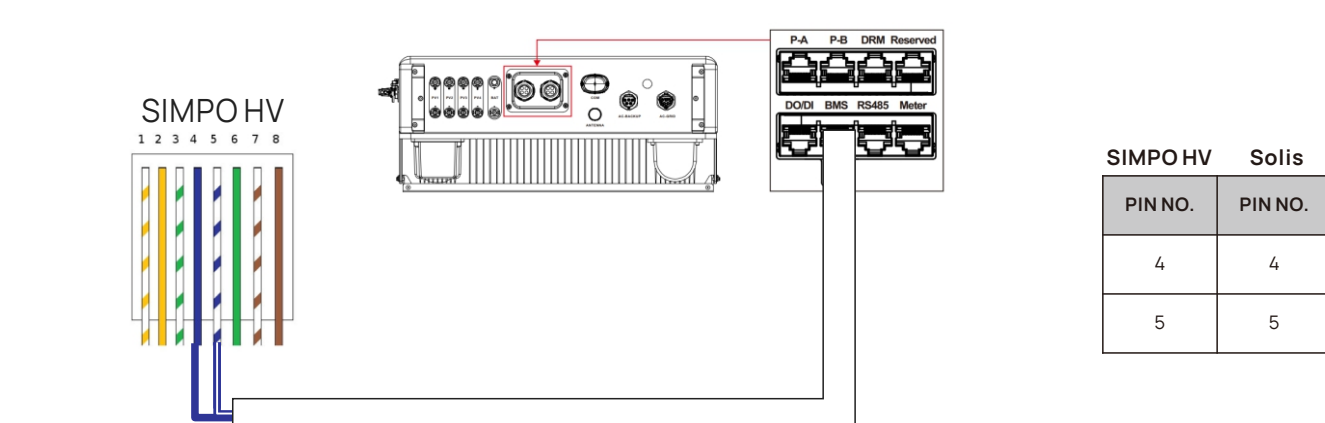

Connecting with GoodWe Inverters

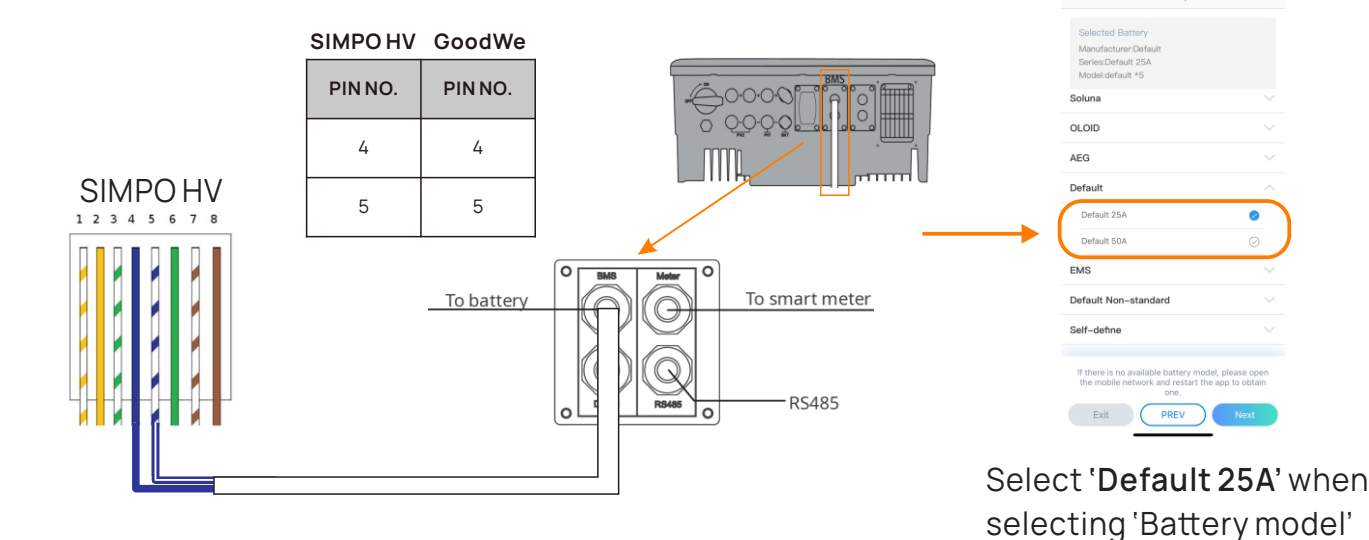

7

ZYC ENERGY CO., LTD

+86 (0)755-2839 4019

WhatsApp: +86 19168831702

Start Up

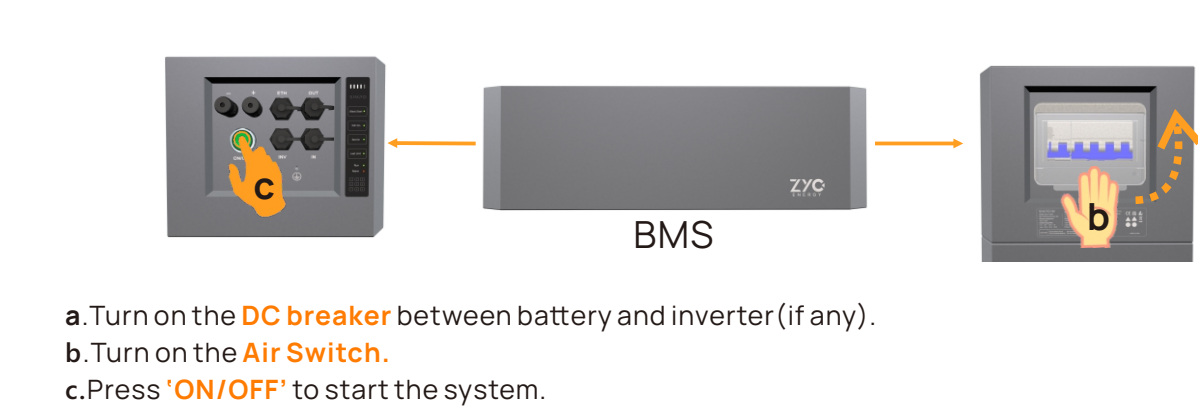

Connect to Internet & ZYC Portal & ZYC Assist

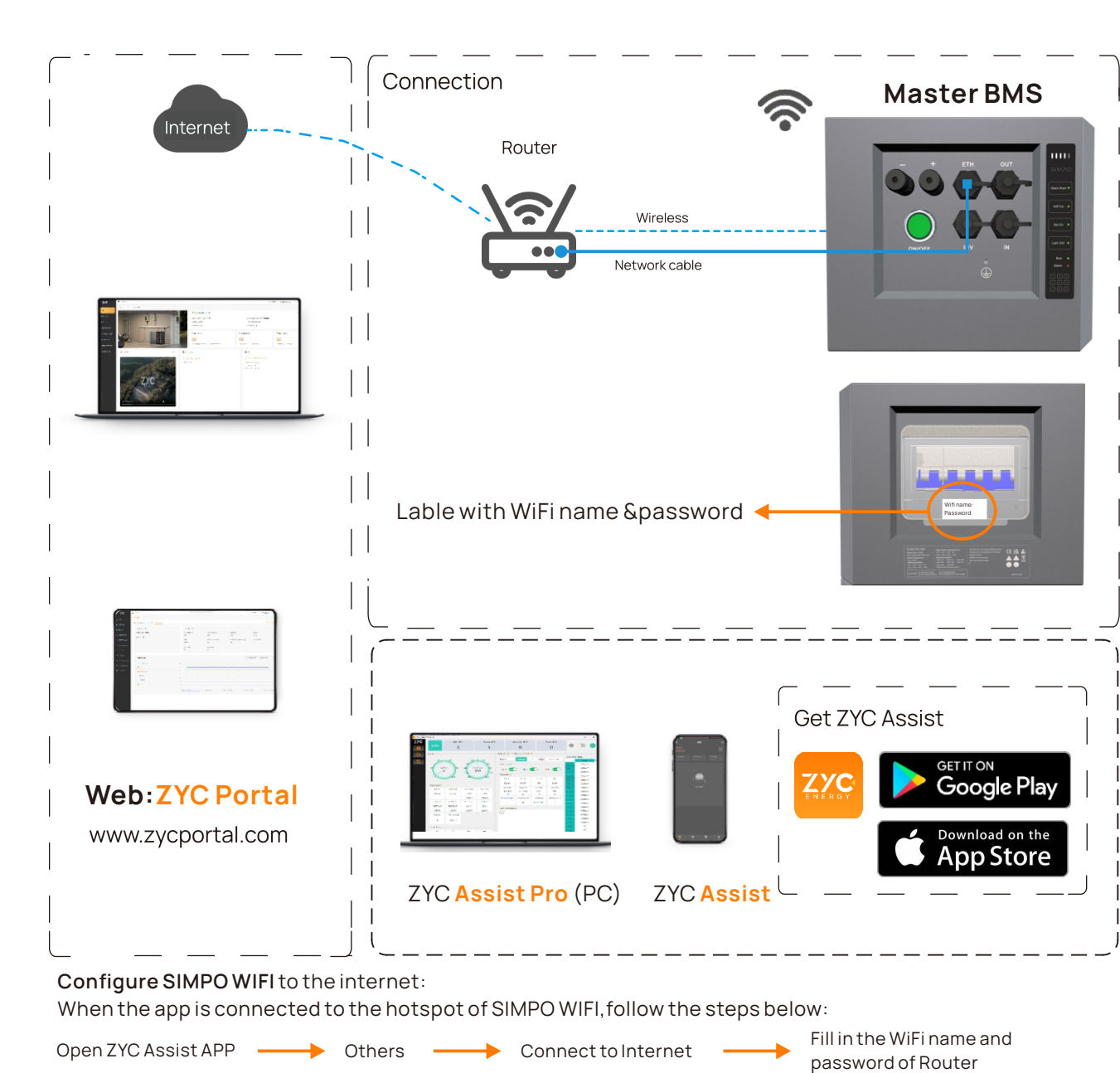

8

sales@zyc.energy / service@zyc.energy

www.zyc.energy / www.zycportal.com